



# Public Document Pack

## Cambridge City Council

### **WEST / CENTRAL AREA COMMITTEE**

**To:** Councillors Kightley (Chair), Bick (Vice-Chair), Cantrill, Dixon, Hipkin, Reid, Rosenstiel, Smith, Zmura, Brooks-Gordon, Nethsingha and Whitebread

*Despatched: Wednesday, 15 September 2010*

**Date:** Thursday, 23 September 2010

**Time:** 7.30 pm

**Venue:** Small Hall - The Guildhall

**Contact:** Glenn Burgess

**Direct Dial:**

## **PRESENTATION**

This page is intentionally left blank

# Midsummer Common & Jesus Green Tree Planting Scheme



A West/Central Area Committee  
Environmental Improvement  
Scheme for 2010/11

# MIDSUMMER COMMON & JESUS GREEN TREE PLANTING SCHEME

- Introduction  
Councillor Rod Cantrill, Executive Councillor for Arts & Recreation
- Historic Context  
John Preston, Historic Environment Manager
- Public Consultation & Resulting Planting Proposals  
Andrew Preston, Environmental Projects Manager
- Questions

# HISTORIC CONTEXT

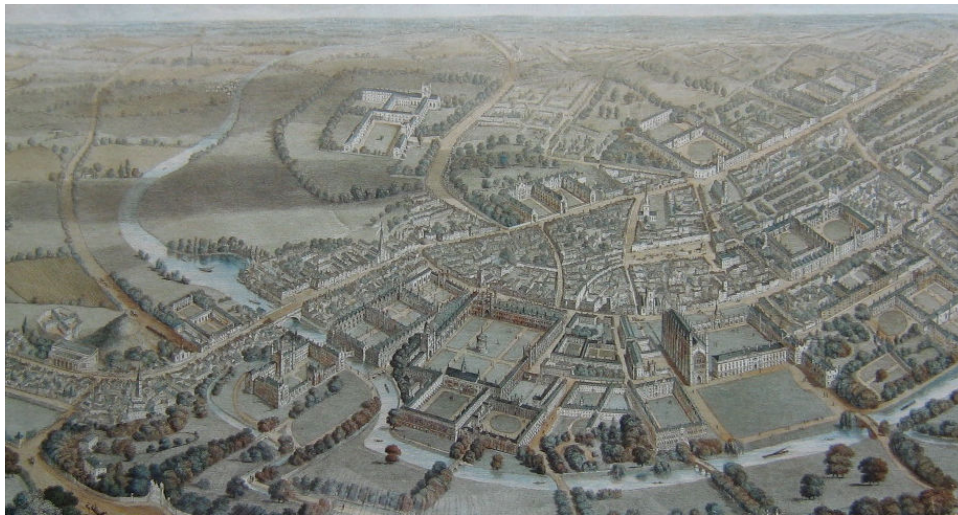

John Preston

*Historic Environment Manager*

# THE WIDER CONTEXT

- Tree planting strategy for spaces to be set in context of Cambridge as a whole

## Significance

- Green river corridor through the city
- Sequence of historic riverside green spaces
- From Grantchester Meadows to the Lents and Mays course

## Issues and Challenges

- Many studies over the years incl Jesus Green and Midsummer Common Conservation Plans

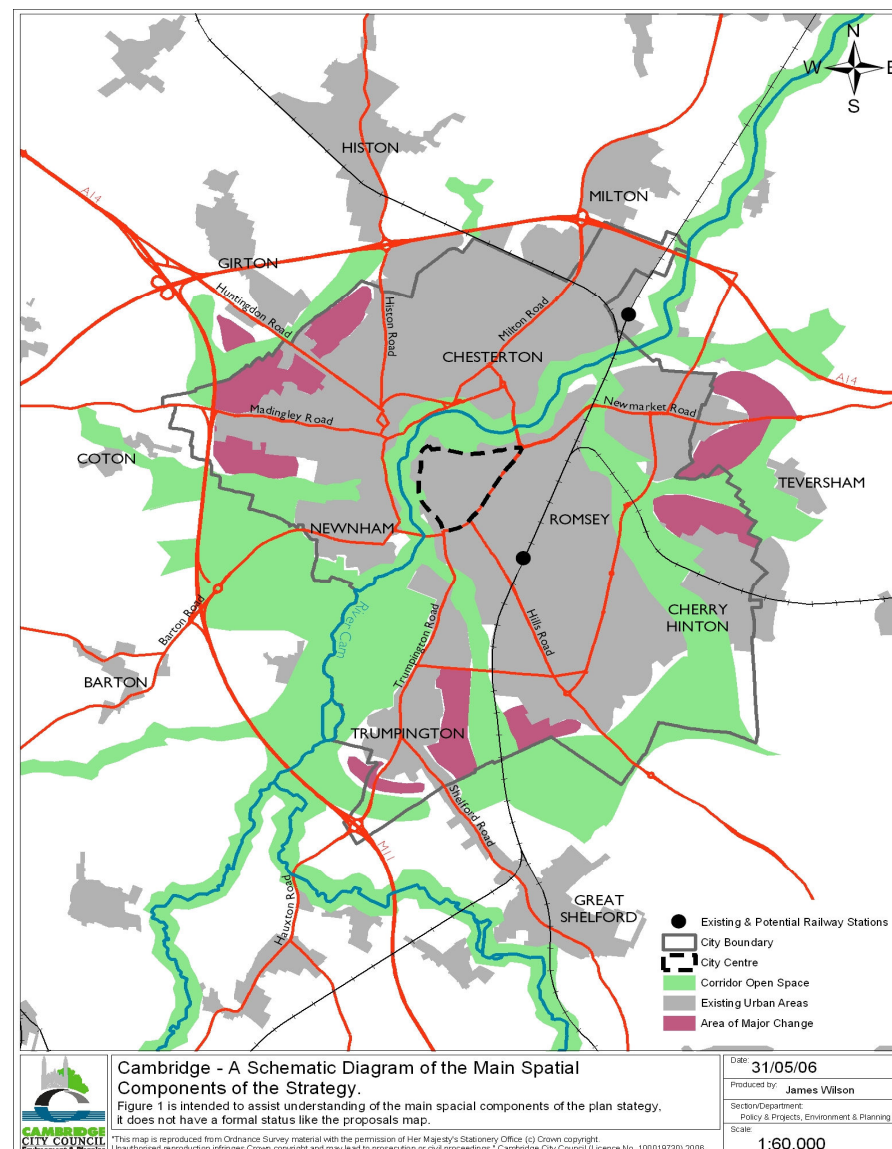

# HISTORIC ENVIRONMENT

“All aspects of the environment resulting from the interaction between people and places through time, including all surviving physical remains of past human activity, whether visible, buried or submerged, and landscaped and planted or managed flora.”

(PPS5, Planning and the Historic Environment, 2010)

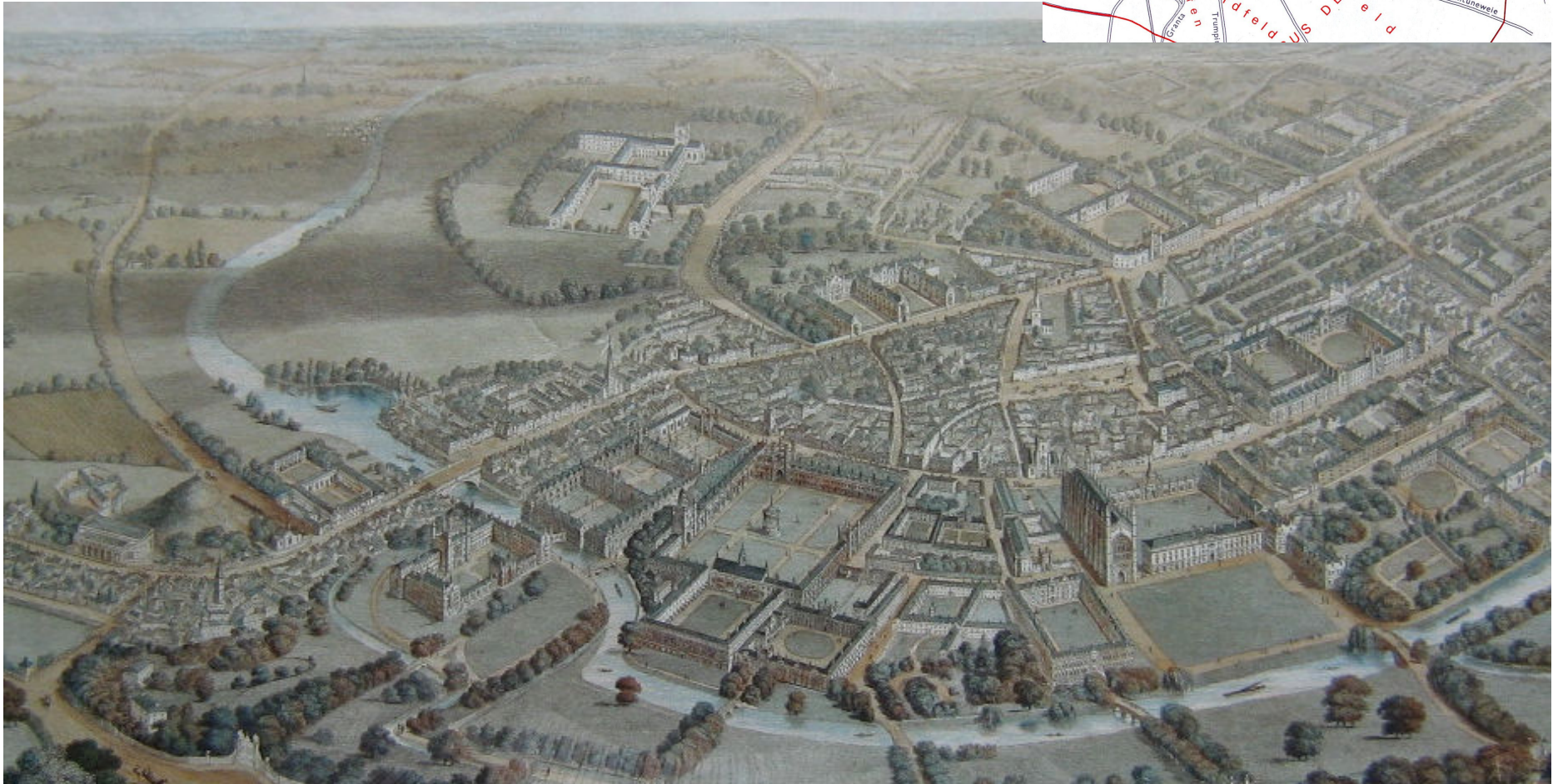
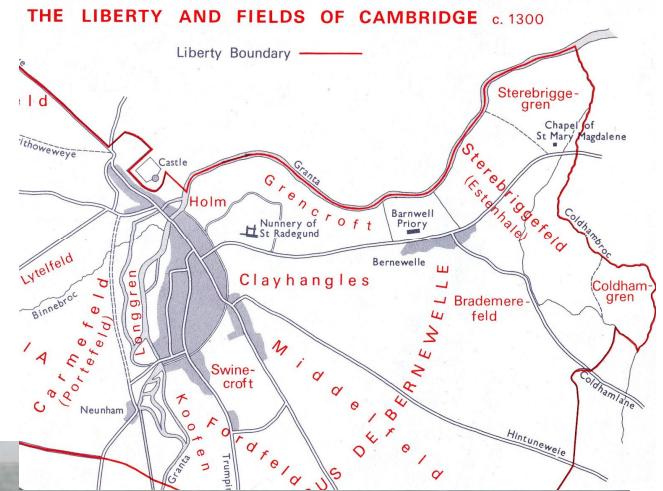

## KEY STRATEGIC ISSUES

### MAINTAINING THE SPECIAL CHARACTER OF CAMBRIDGE

- Large scale trees are a vital part of Cambridge's character, spaces and streets

### CLIMATE CHANGE

- Trees can play a significant role in mitigating climate change impacts
- Species selection will be key to maintaining character in a changed climate

### REGENERATING THE TREE STOCK

- The planted landscape is largely c19; large scale renewal will be needed

For all of these.....

***LONG-TERM THINKING IS VITAL!***





## CITY-WIDE STRATEGIES (in preparation)

### ARBORICULTURE STRATEGY 2010-2014

- New strategy needed to replace 1997-2007 Strategy, and meet new challenges
- Will cover trees in both public and private ownership
- Linkages with Historic Environment Strategy
- Draft started, progress dependent on capacity
- **Public consultation early 2011?**

### HISTORIC ENVIRONMENT STRATEGY

- Over-arching strategic policy (Supplementary Planning Document)
- Strategic support for Conservation Area Appraisals and other policies
- Draft started, initial informal consultation
- Key issues and priorities identified
- Significance, Climate Change, Growth, Access, Managing Change, Quality of Change
- Linkages with Arboriculture Strategy
- Conservation Area Appraisals provide evidence base
- **Public consultation late 2010-early 2011**

# CONSERVATION AREAS AND POLICIES

- **Central area designated 1969**
- **Riverside extension 1993**
- Kite Area Appraisal 1996
- **Historic Core Appraisal 2006**
- Assesses significance
- Street analyses
- Vulnerability to change
- Planning policies
- Management policies

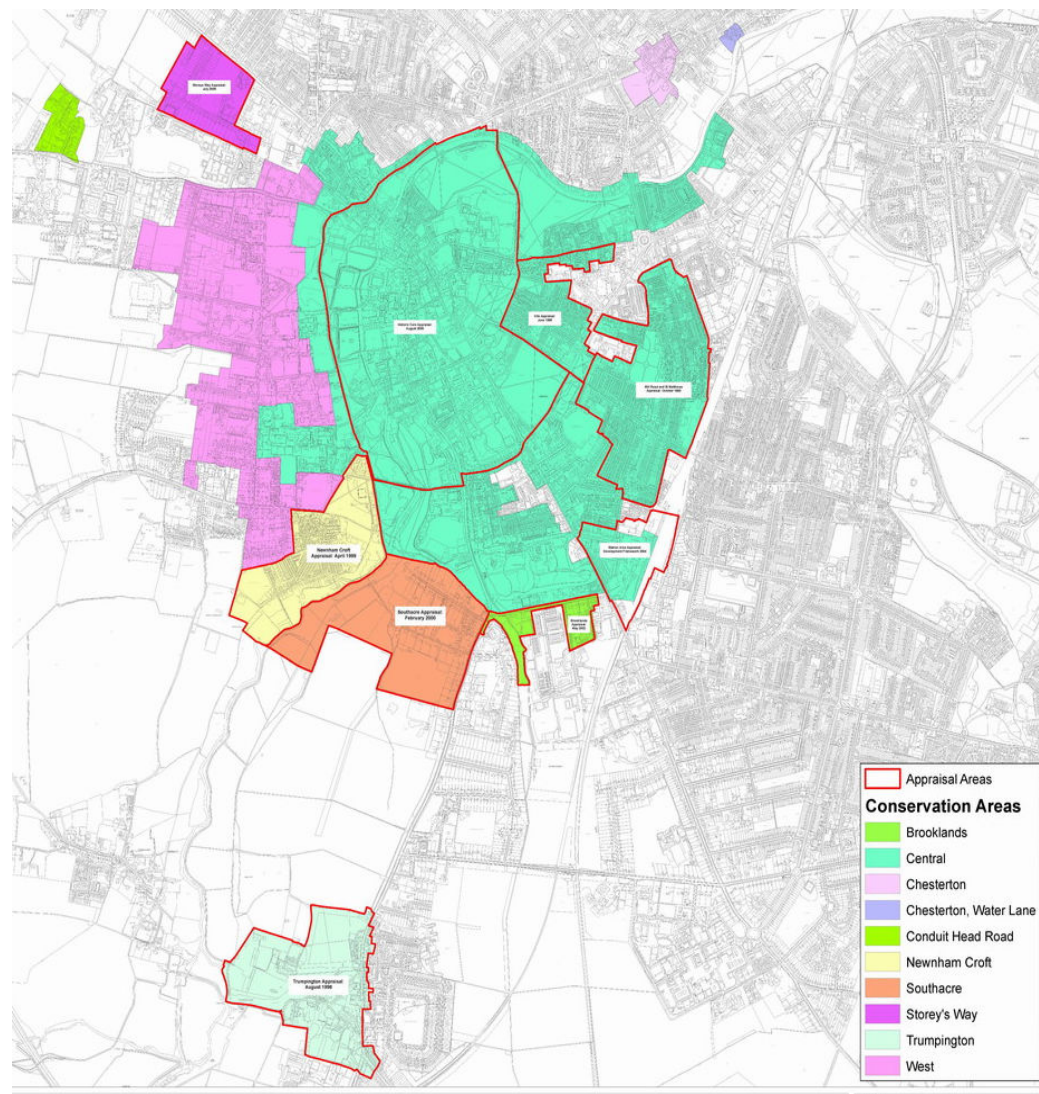

# HISTORIC CORE CONSERVATION AREA APPRAISAL



## JESUS GREEN

- <http://www.cambridge.gov.uk/public/pdfs/Jesus%20Green.pdf>

## VICTORIA AVENUE

- <http://www.cambridge.gov.uk/public/pdfs/Victoria%20Avenue.pdf>

Cross-referenced to Jesus Green and Midsummer Common Conservation Plans

### Jesus Green

**Attractive park and recreation ground created by the Corporation in the late C19.**

Jesus Green is one half of an area of water meadow that was bisected in 1890 by the construction of Victoria Avenue; the other half became Midsummer Common. The Cambridge Corporation was granted rights over the common

land in 1884 and 1922, but it was not heavily used as a recreation ground until the 1920s. Today, the green retains its role as an area for formal and informal recreation, which is crossed by well-used pedestrian and cycle routes.



View across Jesus Green

SIGNIFICANCE - HIGH

#### General Overview

Jesus Green is an important recreational resource used by residents, visitors and schools. It also hosts various performances and events in addition to being an important cycle and pedestrian route. The space also has a wider ecological significance as part of the river corridor.



### Victoria Avenue

**An attractive road through one of the city's main areas of open space constructed in 1890.**

Victoria Avenue and Victoria Bridge were laid out in 1890 and bisected a long strip of low-lying riverside pasture, now known as Jesus Green and Midsummer Common. This was probably the most significant change to the common since the

establishment of Barnwell Priory 800 years earlier. The bridge replaced the many ferry crossings points that connected Chesterton to Cambridge and the street is now one of the main vehicular routes into the city.

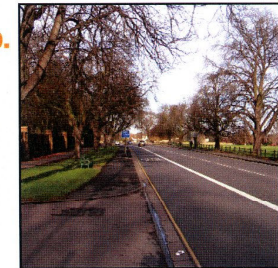

View along Victoria Avenue

SIGNIFICANCE - HIGH

Victoria Avenue is a very wide, linear street south of the river, and one of the main vehicular routes into the city. The few pedestrians that use the generous footpaths are shielded by the canopy of trees and the grass verge. North of the river, however, the street becomes much more enclosed and the buildings offer scope for renovation and redevelopment.

To the south of the river, Jesus College playing fields occupy the land to the southwest and the rest of the land is used for recreational purposes. North of the river is a mixture of retail and domestic use and a drop-in and resource centre for the homeless.

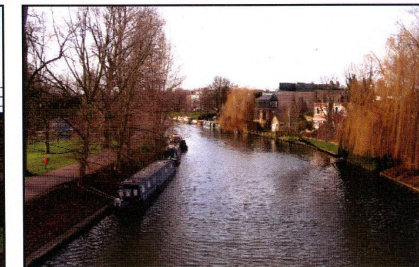
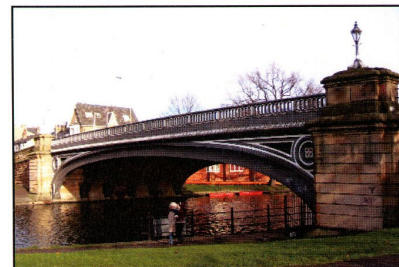

# HISTORIC CORE APPRAISAL STREET AND SPACE ANALYSES

Identify significant trees, key views etc  
**JESUS GREEN AND VICTORIA AVENUE**  
 (Midsummer Common not part of the Appraisal)

Page 10

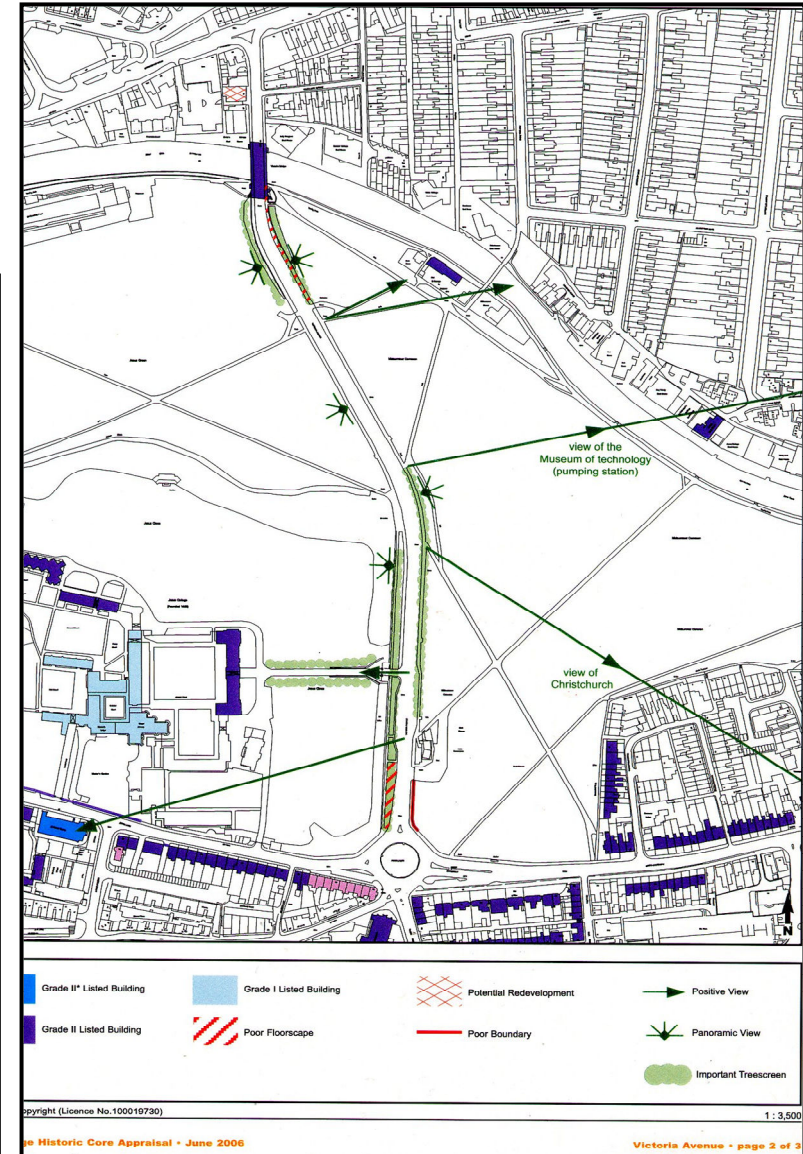
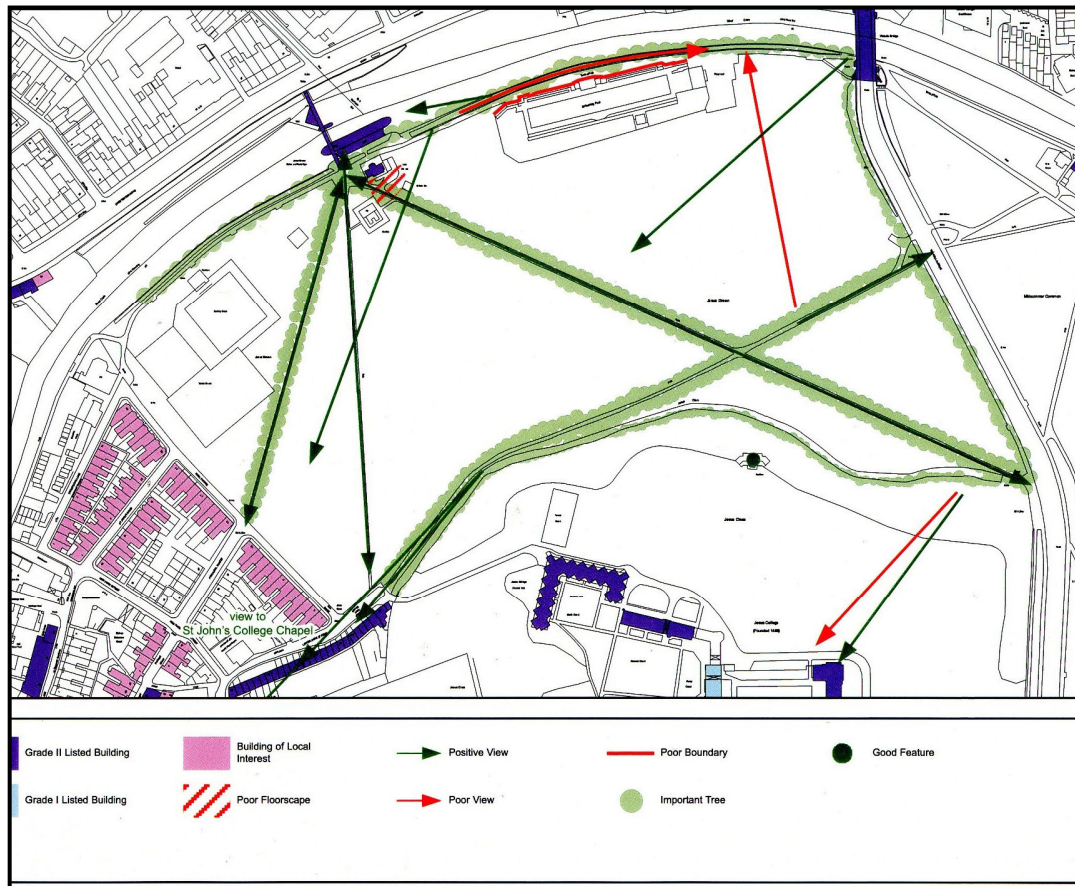

# PRO-ACTIVE CONSERVATION PROGRAMME 2008-2011

## All existing Conservation Areas to have an Appraisal

- De Freville designated 2009, Chesterton & Ferry Lane reviewed 2009
- West Cambridge current consultation (exhibition 24-25 September 2010)
- **Midsummer Common** assessed as part of Riverside Appraisal 2010
- plus Newmarket Road Suburbs and Approaches study 2010
- trees and landscape assessed
- drafts by consultants

Public consultation Autumn 2010

All completed appraisals at  
<http://www.cambridge.gov.uk/ccm/navigation/planning-and-building-control/historic-environment-and-trees/>

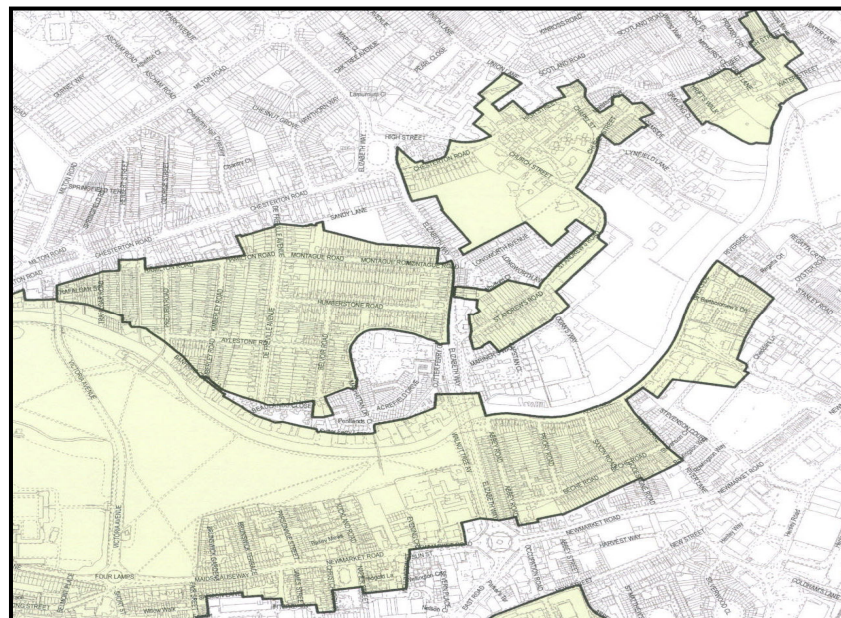

# DRAFT RIVERSIDE CONSERVATION AREA APPRAISAL

First draft received from consultants

Being prepared for consultation  
(with Newmarket Road study)

Dates to be confirmed

“A backcloth of trees surrounds the commons, softening and at times hiding the built-up area beyond.

The commons form part of a green wedge which penetrates the City east to west.

The Commons are important open spaces visually, for informal recreation and for wildlife. They bring countryside into the heart of a busy city.”

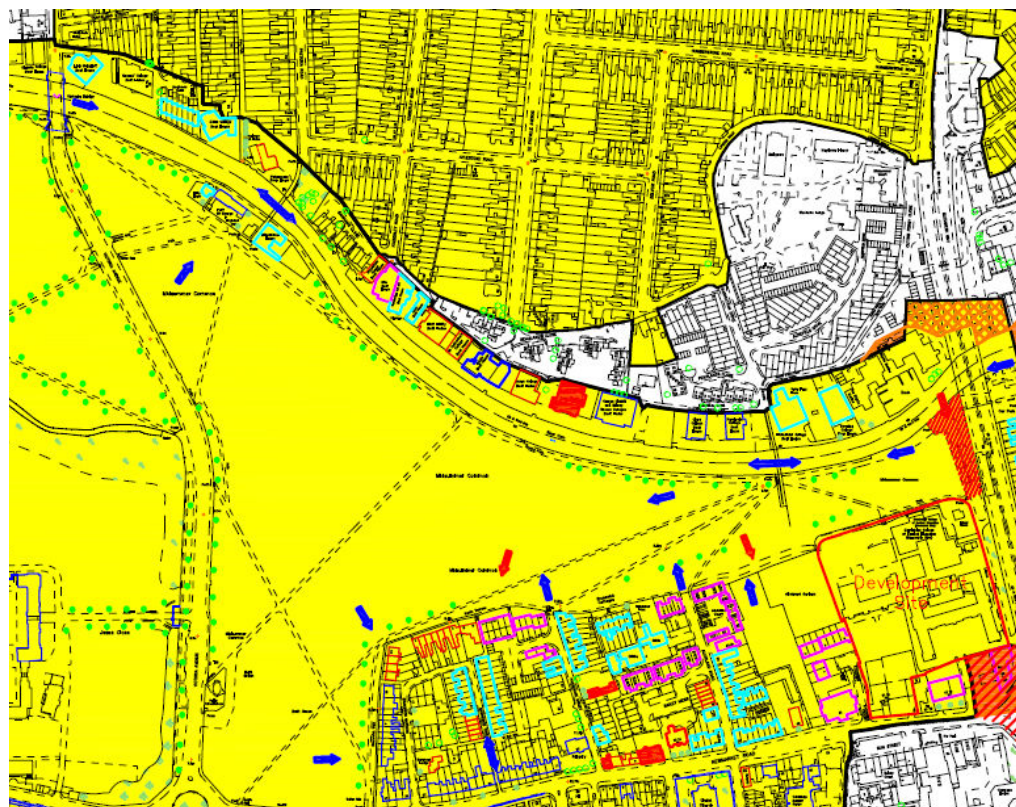

# PUBLIC CONSULTATION & RESULTING PROPOSALS



Andrew Preston  
*Environmental Projects Manager*

# Public Consultation

- Public Workshop held in early July.
- City wide Public Consultation carried out from 26<sup>th</sup> August to 10<sup>th</sup> September.
- Exhibitions held on Midsummer Common & Jesus Green which were well attended with over 150 leaflets handed out.
- The questionnaire and proposals were available electronically online and at the Customer Service Centre.
- A total of 267 responses to the questionnaire have been received.





# CAMBRIDGE CITY COUNCIL

## TREE PLANTING ON JESUS GREEN AND MIDSUMMER COMMON

This questionnaire is accompanied by a plan showing the proposals and their locations. We would welcome your views. In each question there is space which can be used to expand your answer or give us more feedback.

**WAYS TO RETURN YOUR RESPONSE FORM:**

1. Complete the on-line survey form which you will find at [www.cambridge.gov.uk](http://www.cambridge.gov.uk), OR
2. Download, complete and email to [parks@cambridge.gov.uk](mailto:parks@cambridge.gov.uk), OR
3. Visit the Cambridge City Council Customer Service Centre, Mandela House, Regent Street, Cambridge and complete the questionnaire, OR
4. Visit our manned exhibitions on Midsummer Common on Thursday 26th August 2010 between 3.00p.m. and 6.00p.m. or on Jesus Green on Saturday 4th September 2010 between 10.00a.m. and 3.30p.m. and respond there.

Please respond by noon on 10<sup>th</sup> September 2010 in order for your comments to be considered.

**1 Are you responding to this consultation....**  
**PLEASE TICK ONLY ONE BOX**

- a) As a private individual  1
- b) On behalf of a group or organisation  
(please tell us which one)  2
- c) In some other capacity  
(please tell us what your interest is)  3

**QUESTIONS 2 – 7 RELATE TO MIDSUMMER COMMON ONLY**

**2 The Common is well used by the public in many ways. In order to retain its key functions, e.g. as Midsummer and Strawberry Fairs, the centre of the Common should be kept open. Historically single trees have been planted to indicate where footpaths and bridges meet the Common, the Council would like to continue planting in these locations.**

- |                                                                 | Strongly Agree             | Agree                      | Unsure                     | Disagree                   | Strongly Disagree          |
|-----------------------------------------------------------------|----------------------------|----------------------------|----------------------------|----------------------------|----------------------------|
| a) Keep central area of common clear for fairs etc.             | <input type="checkbox"/> 1 | <input type="checkbox"/> 2 | <input type="checkbox"/> 3 | <input type="checkbox"/> 4 | <input type="checkbox"/> 5 |
| b) Identify entrances/exits to the common with individual trees | <input type="checkbox"/> 1 | <input type="checkbox"/> 2 | <input type="checkbox"/> 3 | <input type="checkbox"/> 4 | <input type="checkbox"/> 5 |

Comments

**3** On the riverside at Midsummer Common the priorities are to restore the historic planting layout and to plant trees to frame the Fort St George public house.

**Area A** Please tell us whether you like these proposals or not.

Refer to plan

- |                                                                                                                                  | Strongly Agree             | Agree                      | Unsure                     | Disagree                   | Strongly Disagree          |
|----------------------------------------------------------------------------------------------------------------------------------|----------------------------|----------------------------|----------------------------|----------------------------|----------------------------|
| a) Remove young mixed specie trees to the west of the Fort St. George public house and replace with willow (managed as pollards) | <input type="checkbox"/> 1 | <input type="checkbox"/> 2 | <input type="checkbox"/> 3 | <input type="checkbox"/> 4 | <input type="checkbox"/> 5 |
| b) Retain the mature London Plane to the east of Fort St. George                                                                 | <input type="checkbox"/> 1 | <input type="checkbox"/> 2 | <input type="checkbox"/> 3 | <input type="checkbox"/> 4 | <input type="checkbox"/> 5 |

Comments

**4** On the riverside path between the Fort St George and the Elizabeth Way bridge the proposal is to restore the historic riverside layout and keep the views of the river open. The mature London Planes and the veteran pollarded willows would be retained.

**Area B**

Refer to plan

Which of the approaches below do you prefer?  
**PLEASE TICK ONLY ONE BOX**

- Option a)** Fell remaining young and early mature mixed species and replace with Willows (to be pollarded) at REGULAR spacings and a few Black Poplar in groups behind the Willow  1
- Option b)** Fell remaining young and early mature mixed species and replace with Willows (to be pollarded) at IRREGULAR spacings and a few Black Poplar in groups behind the Willow  2
- Option c)** Don't know/unsure  3

Comments

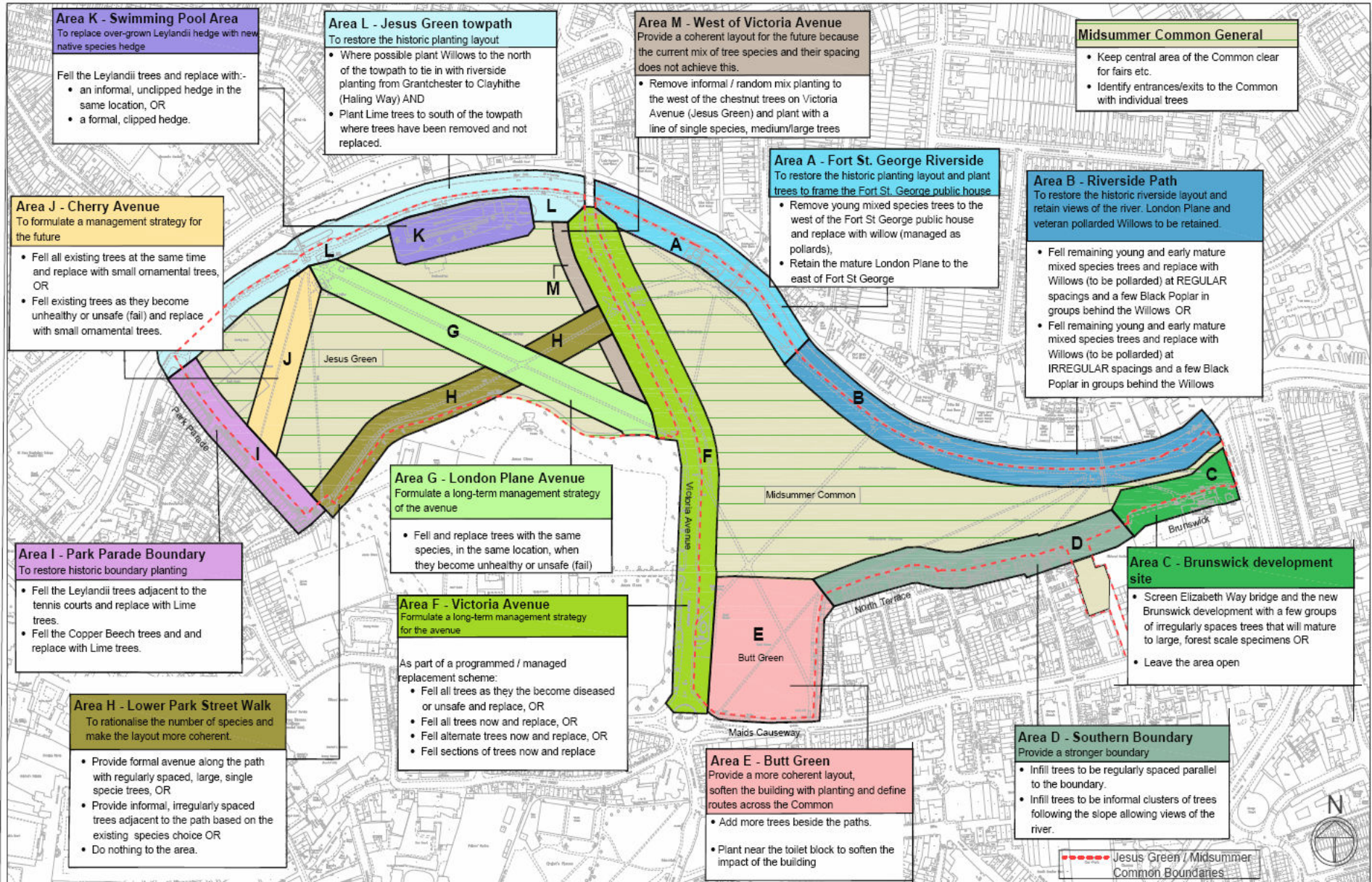

ENVIRONMENT AND PLANNING DEPARTMENT  
Environmental Projects  
CAMBRIDGE CITY COUNCIL

## Tree Planting on Jesus Green and Midsummer Common Environmental Improvement Scheme

### General Notes

- The proposals shown on this drawing have been formulated using ideas from a key stakeholder workshop held on 1 July 2010.
- Please respond to the issues shown using the accompanying questionnaire.
- The closing date for this consultation is noon on the 10 September 2010.

This map is based on Ordnance Survey material with the permission of Her Majesty's Stationery Office © Crown copyright. Unauthorised reproduction infringes Crown copyright and may lead to prosecution or civil proceedings.  
Cambridge City Council (Licence No. 100019730) 2010

## Public Consultation (continued)

- Primarily to consult on the proposed EIP tree planting scheme.
- Opportunity taken to gauge public opinion with regard to future management of the spaces.
- Results will be taken into account when reviewing the existing management plans and conservation plans for these areas.

# Consultation & Resulting Proposals

- 267 Responses to Questionnaire.
- Representation by 8 Organisations or Groups.
- 87.5% in favour of keeping the central area of Midsummer Common clear for fairs etc.
- 84.7% in favour of identifying entrances/exits to the common with individual trees.

# Consultation & Resulting Proposals by Area



## AREA A - Fort St. George Riverside

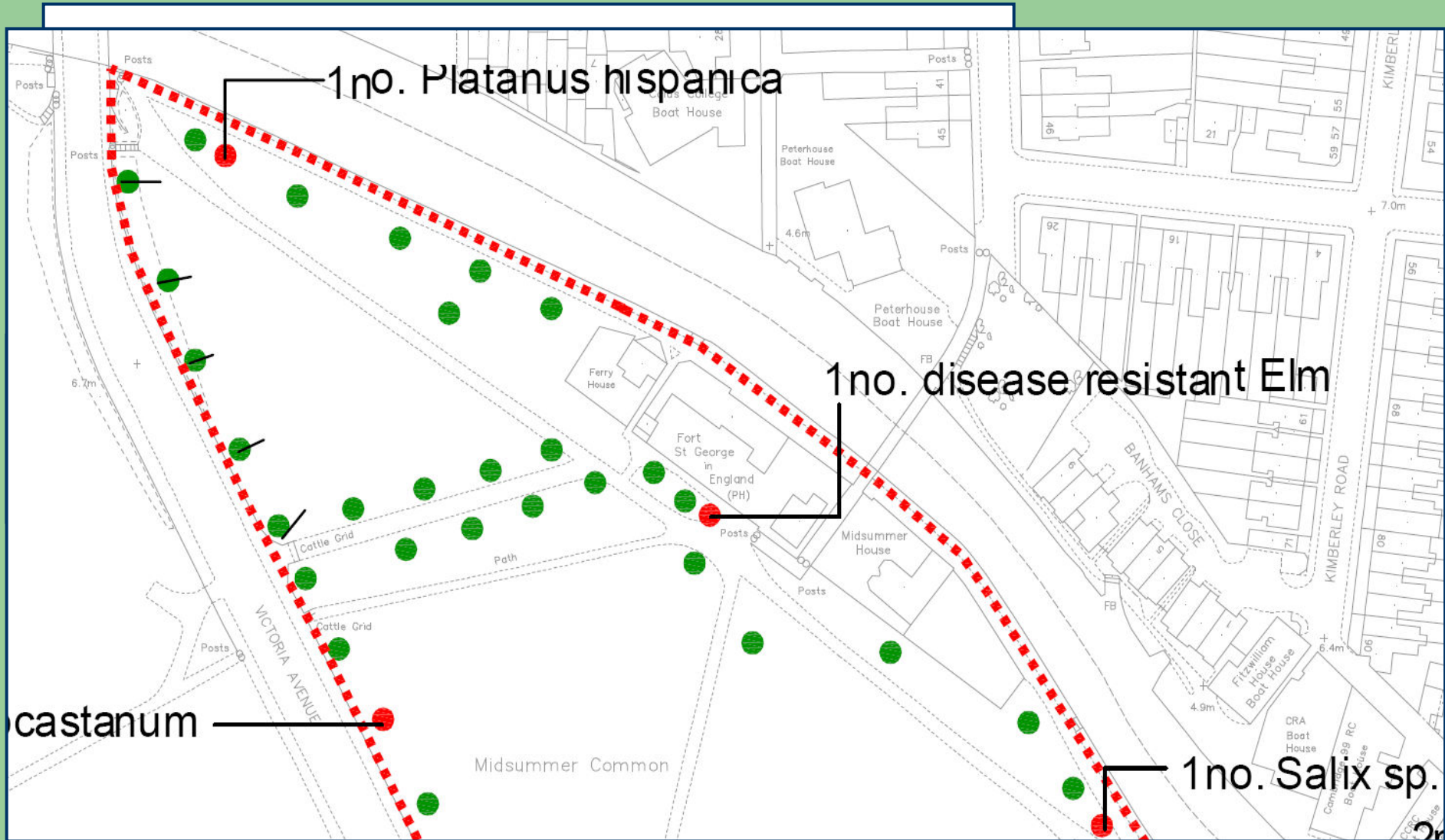

# Consultation & Resulting Proposals by Area

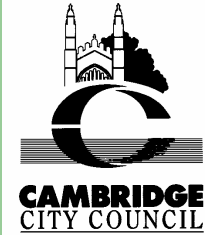

## AREA B - Riverside Path

**Area B - Riverside Path**  
 To restore the historic riverside layout and retain views of the river. London Plane and veteran pollarded Willows to be retained.

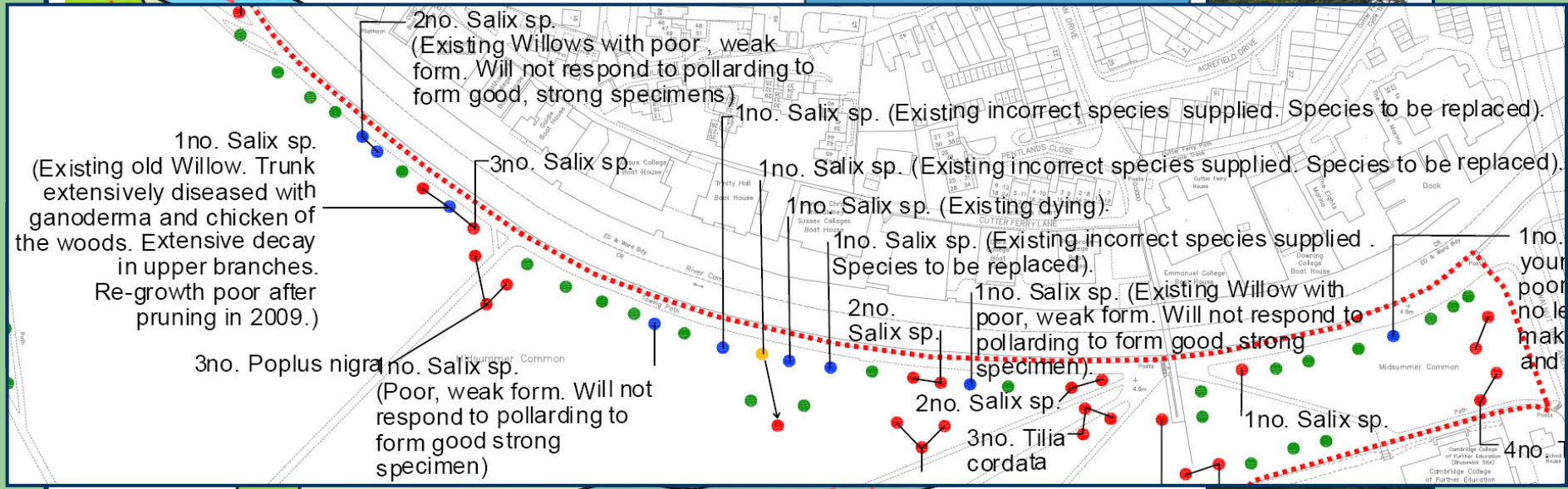

Page 20

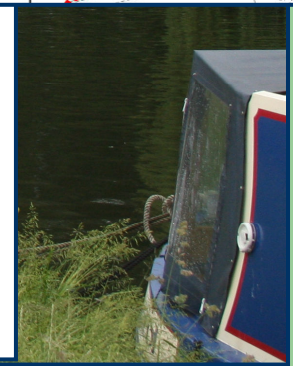
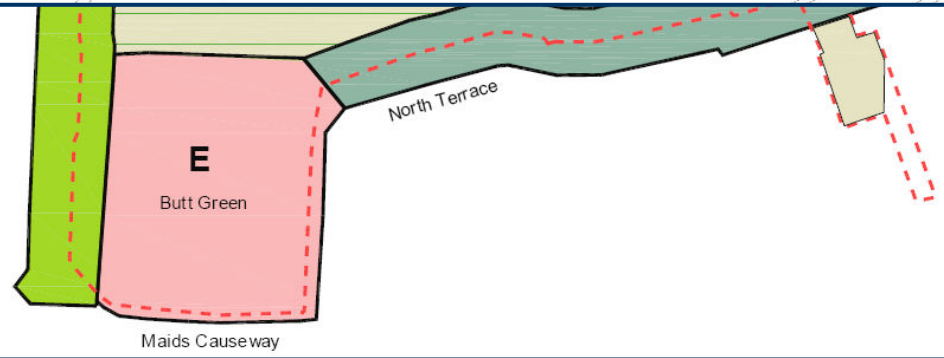

# Trees proposed to be replaced











# Consultation & Resulting Proposals by Area

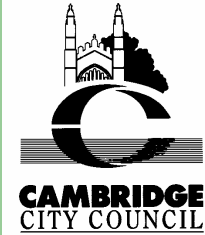

## AREA C - Brunswick Development Area

Page 25

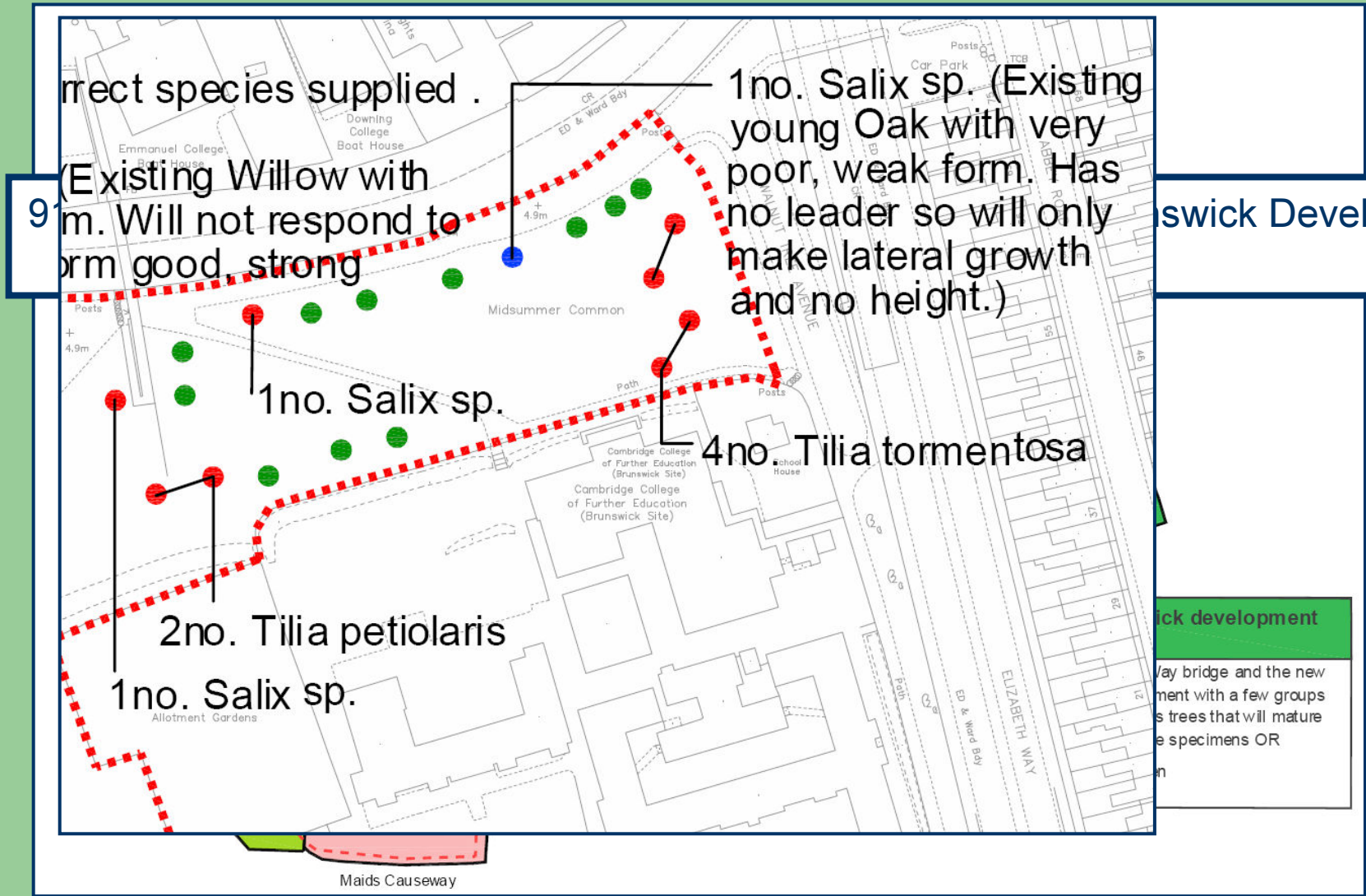

Brunswick Development

Brunswick development

Way bridge and the new  
ment with a few groups  
s trees that will mature  
e specimens OR

# Consultation & Resulting Proposals by Area

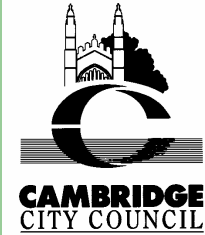

## AREA D - Brunswick Development site to Brunswick Walk

Page 26

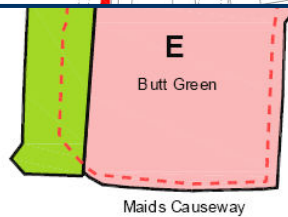
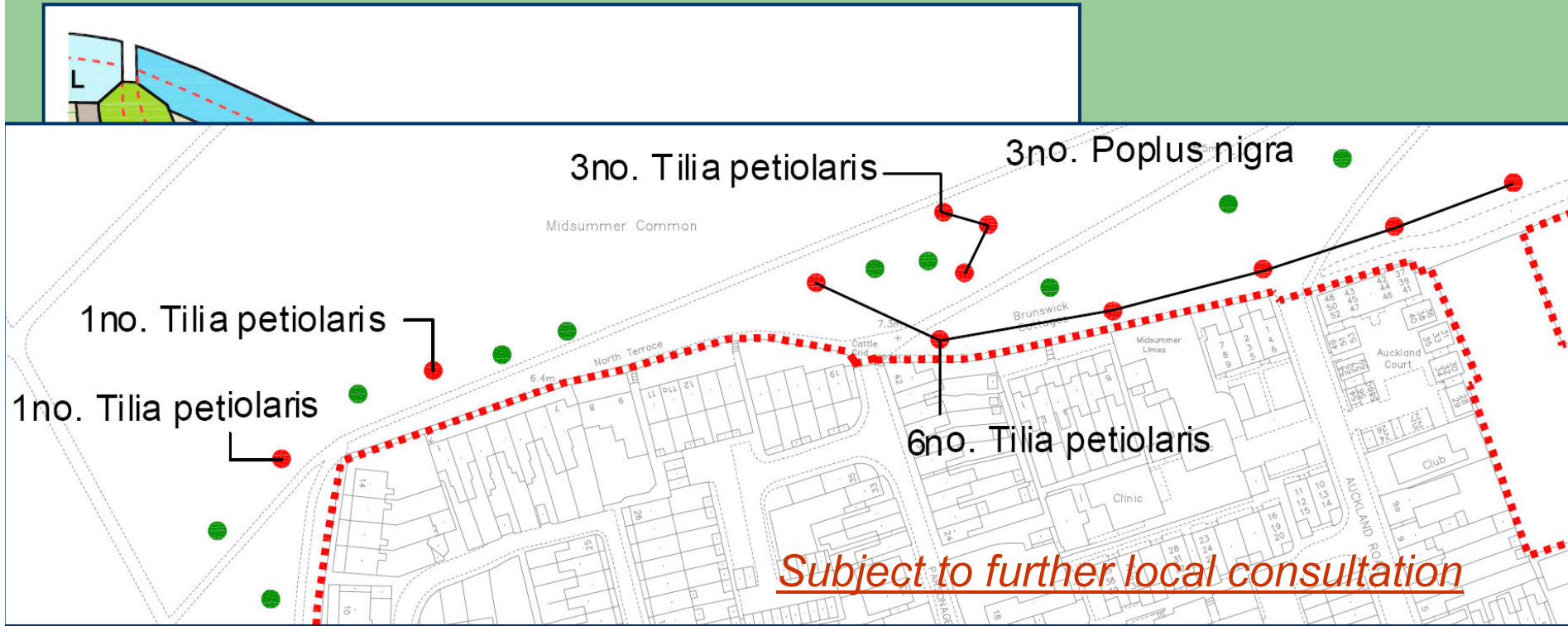

### Area D - Southern Boundary

Provide a stronger boundary

- Infill trees to be regularly spaced parallel to the boundary.
- Infill trees to be informal clusters of trees following the slope allowing views of the river.

# Consultation & Resulting Proposals by Area



## AREA E - Butt Green



Page 27

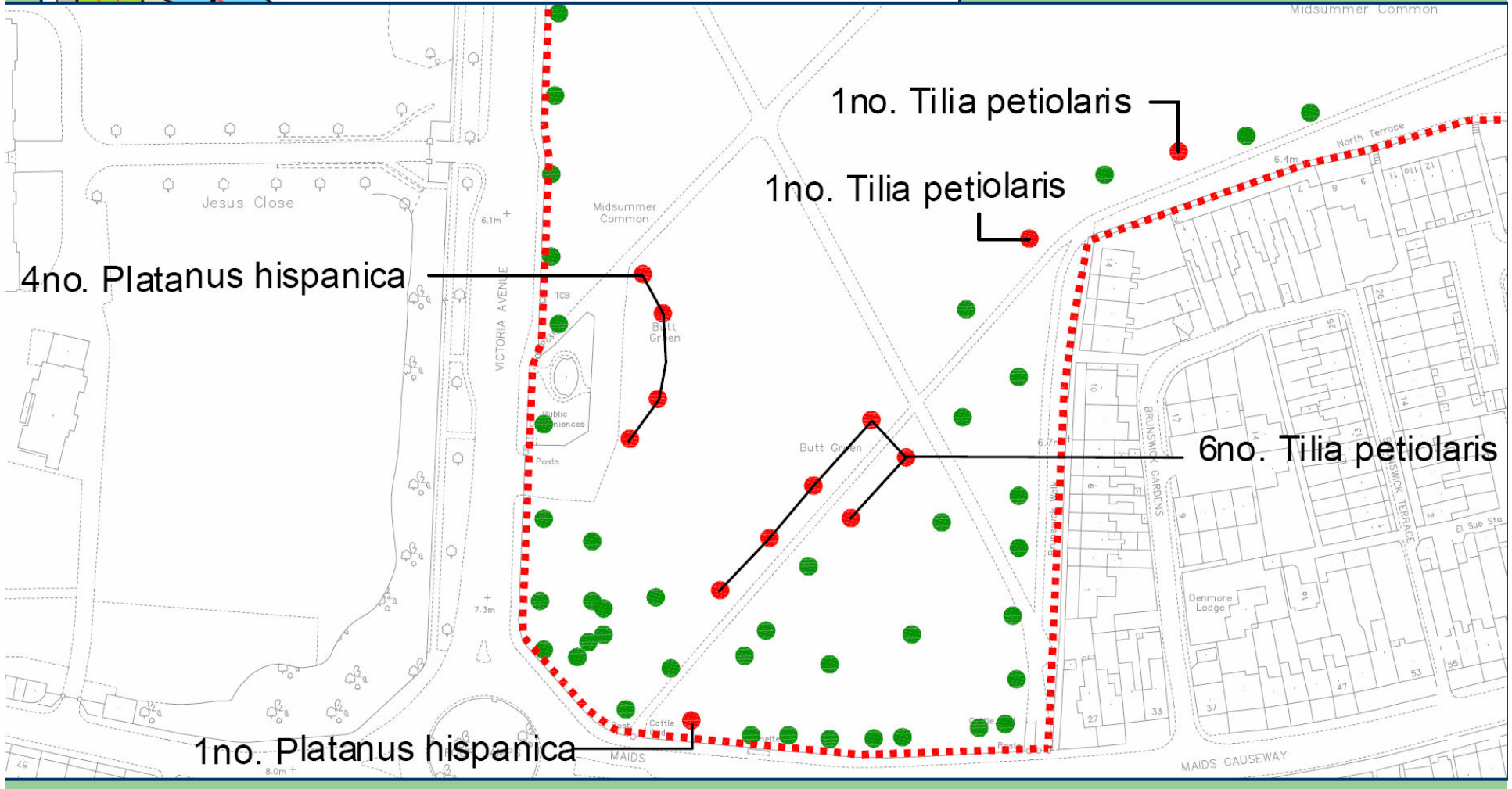

# Consultation & Resulting Proposals by Area



## AREA F - Victoria Avenue (east side)

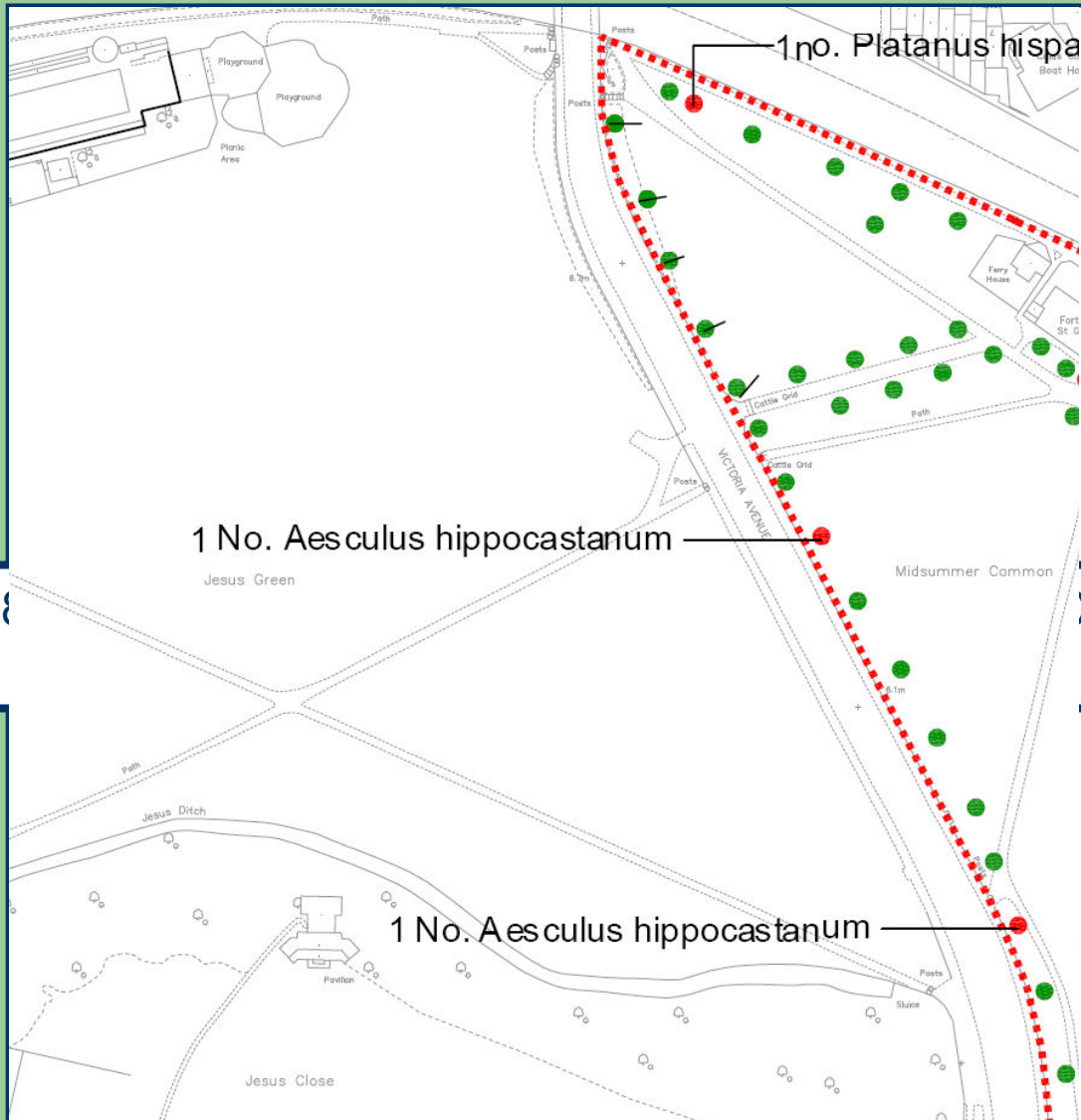

chestnuts as and when they

# Consultation & Resulting Proposals by Area

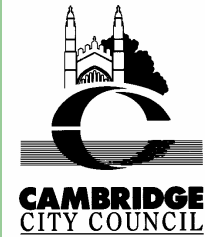

## AREA M - Victoria Avenue (north west)

**NO PROPOSALS FOR THIS AREA**

**Area M - West of Victoria Avenue**  
Provide a coherent layout for the future because the current mix of tree species and their spacing does not achieve this.

- Remove informal / random mix planting to the west of the chestnut trees on Victoria Avenue (Jesus Green) and plant with a line of single species, medium/large trees

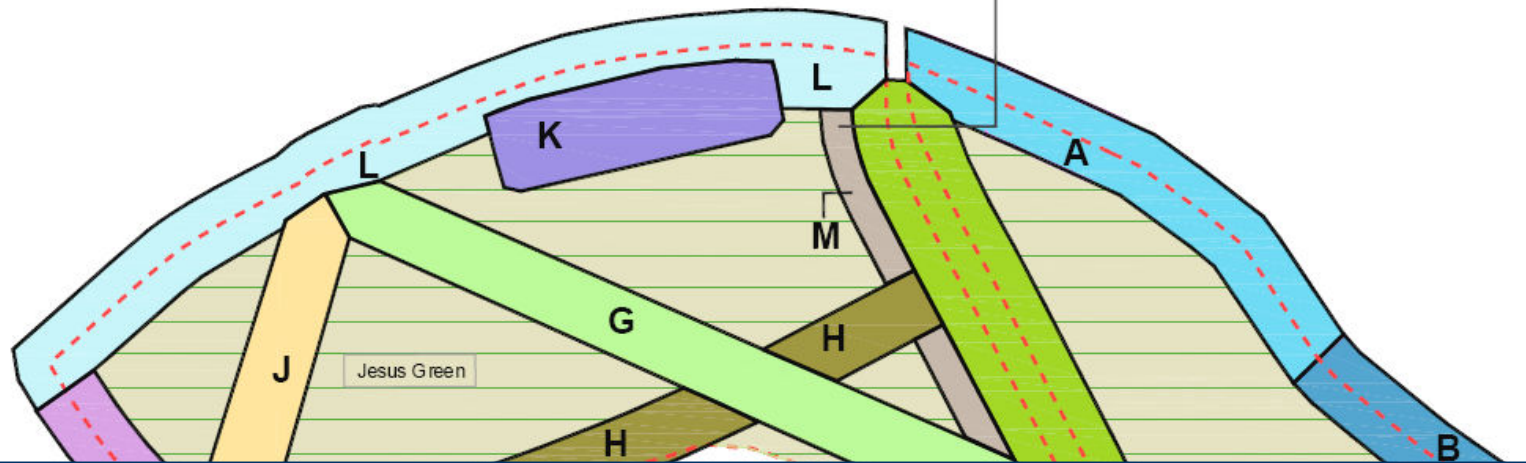

60.2% preferred not to replace random mixed species to the west of Chestnut Avenue.

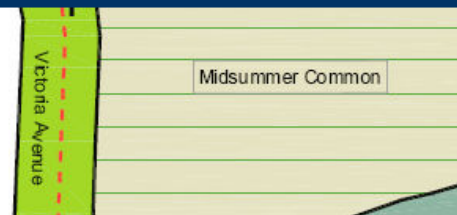

# Consultation & Resulting Proposals by Area



## AREA G - London Plane Avenue

Page 30

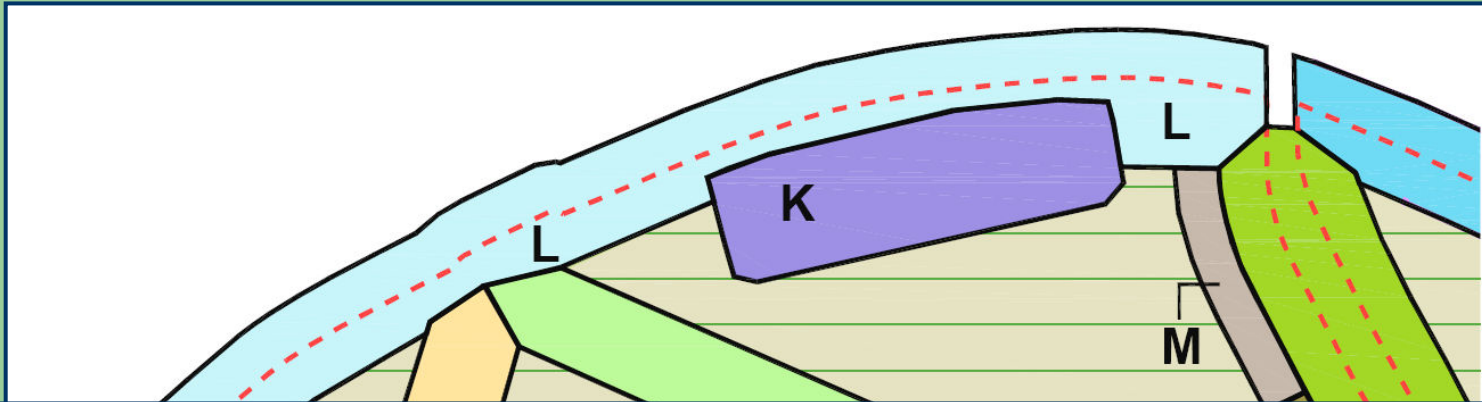

The existing tree management regime will continue with trees replaced as and when they become diseased and/or unsafe.

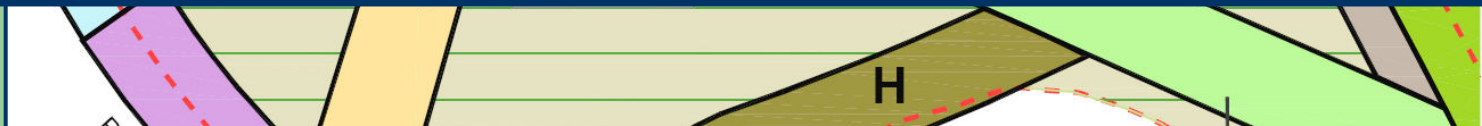

93.1% agreed with the proposed replacement of diseased and/or unsafe trees with the same species.

**Area G - London Plane Avenue**  
Formulate a long-term management strategy of the avenue

- Fell and replace trees with the same species, in the same location, when they become unhealthy or unsafe (fail)



# Consultation & Resulting Proposals by Area



## AREA H - Lower Park Street to Victoria Avenue

Page 31

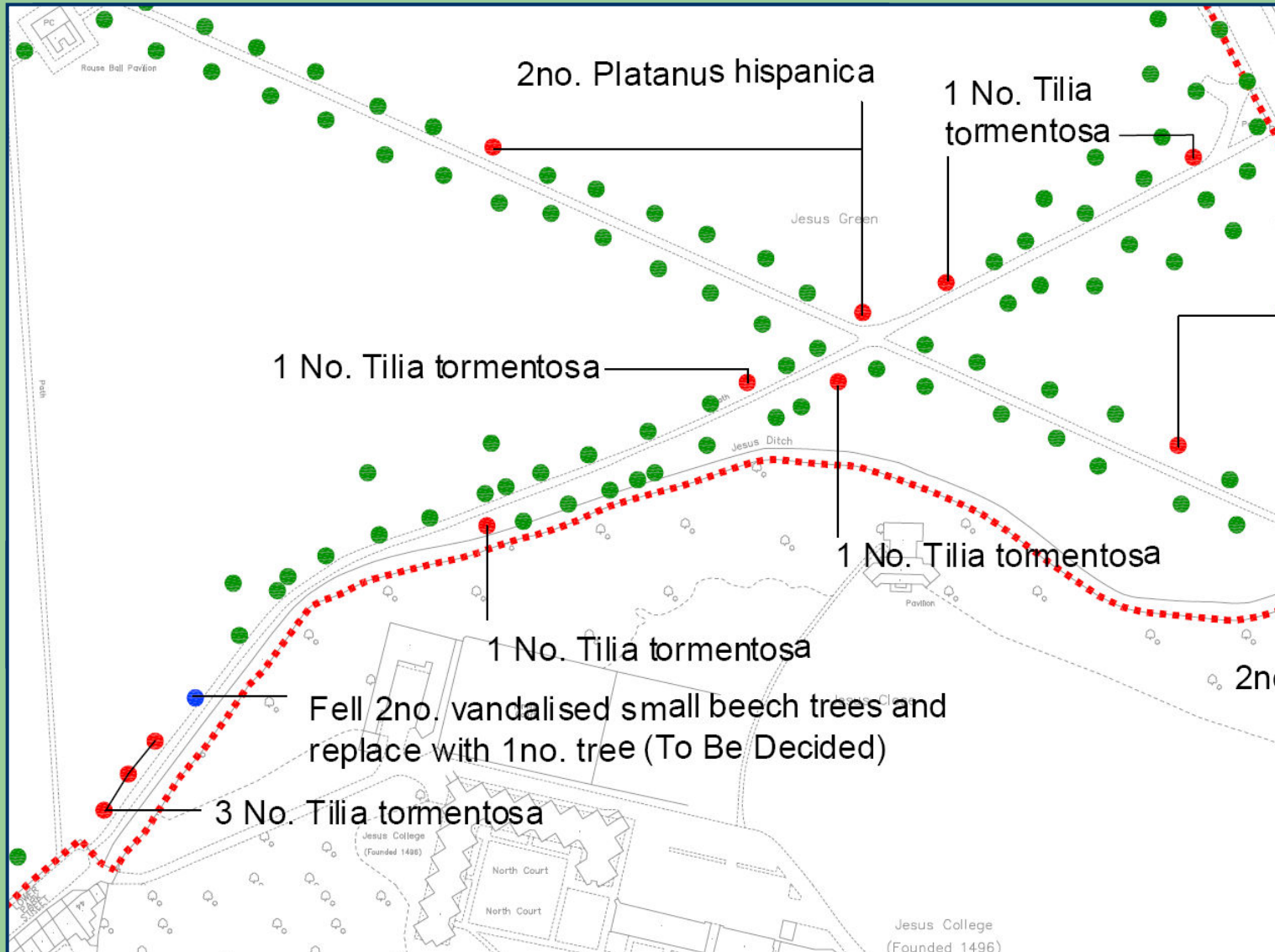

ased on

# Consultation & Resulting Proposals by Area



## AREA I - Park Parade

Page 32

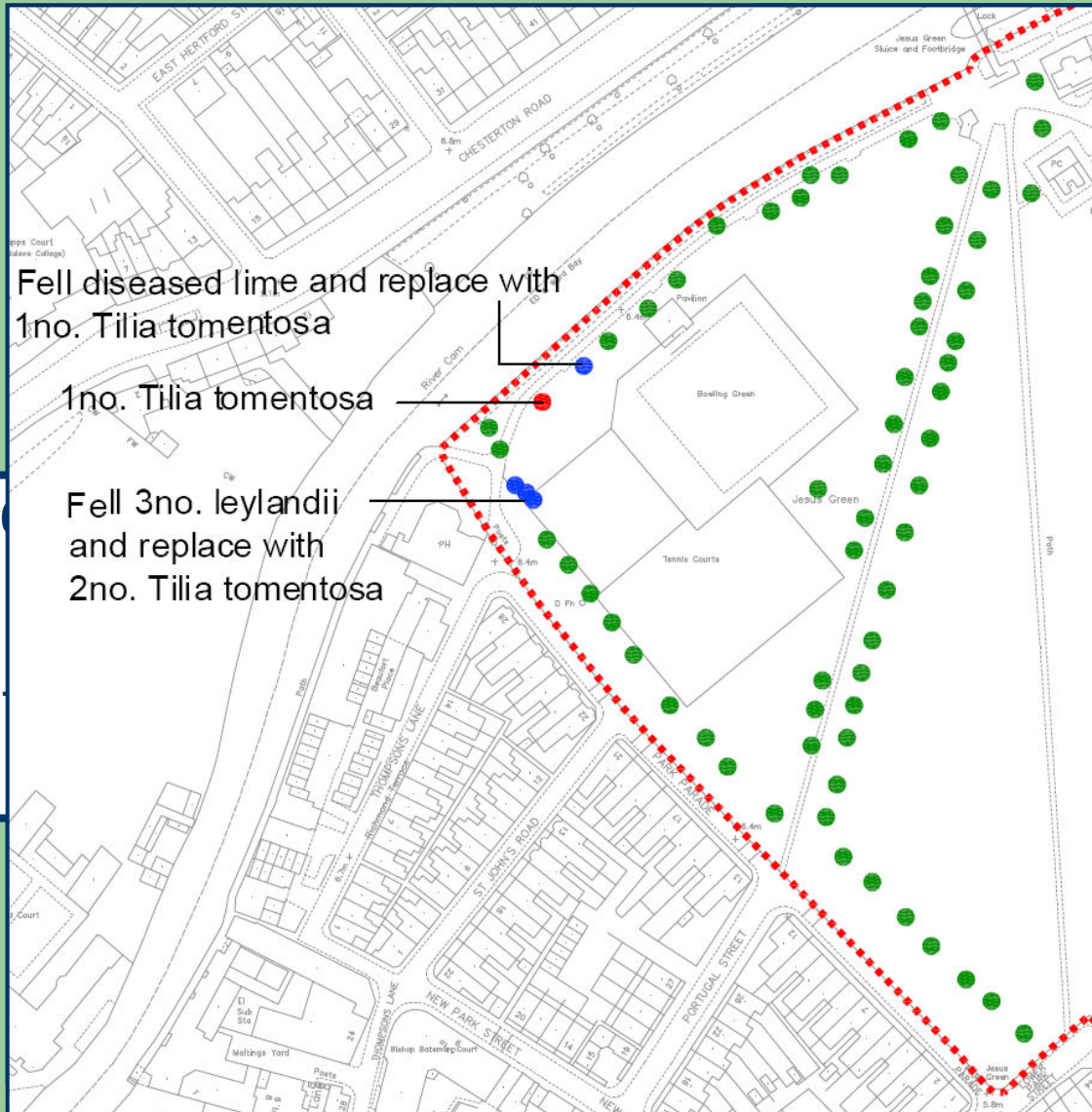

# Consultation & Resulting Proposals by Area



## AREA J - Cherry Avenue

### Area J - Cherry Avenue

To formulate a management strategy for the future

- Fell all existing trees at the same time and replace with small ornamental trees, OR
- Fell existing trees as they become unhealthy or unsafe (fail) and replace with small ornamental trees.

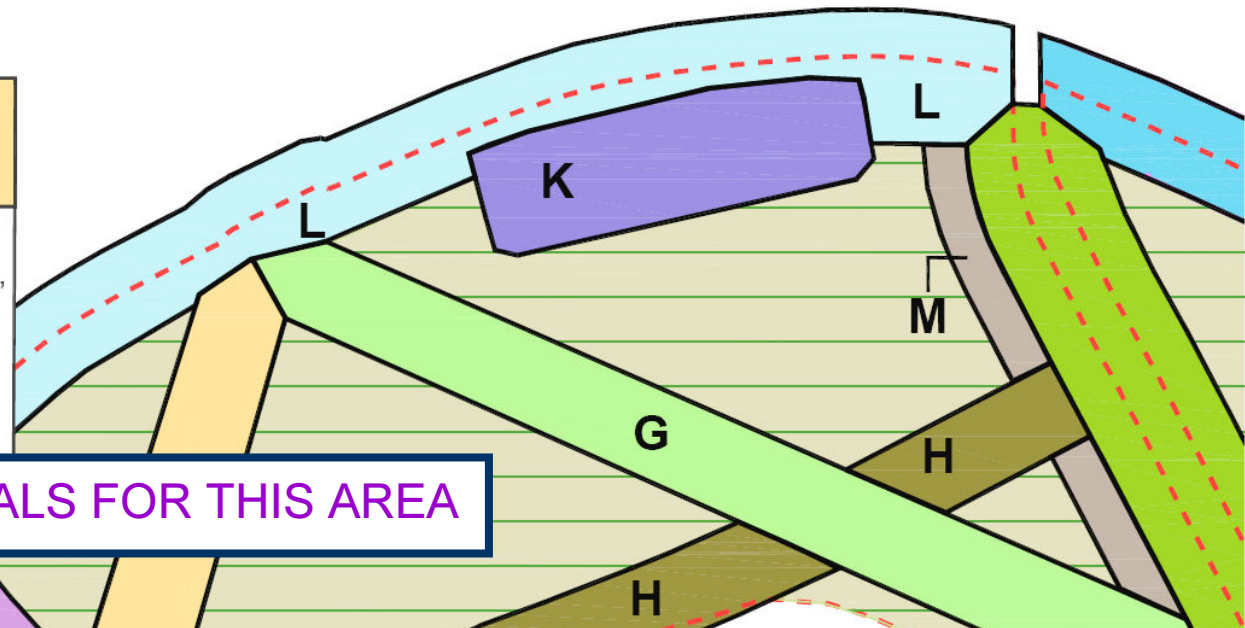

**NO RESULTING PROPOSALS FOR THIS AREA**

78.8% agreed to the approach of replacing the existing cherry trees as and when they become diseased and/or unsafe and replacing them with similar ornamental trees.

# Consultation & Resulting Proposals by Area

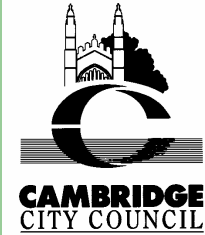

## AREA K - Swimming Pool

Replace leylandii hedge (145m long) with informal unclipped native species hedge (Crataegus monogyna, Corylus avellana, Cornus sanguinea, Euonymus europaeus and Viburnum Opulus)

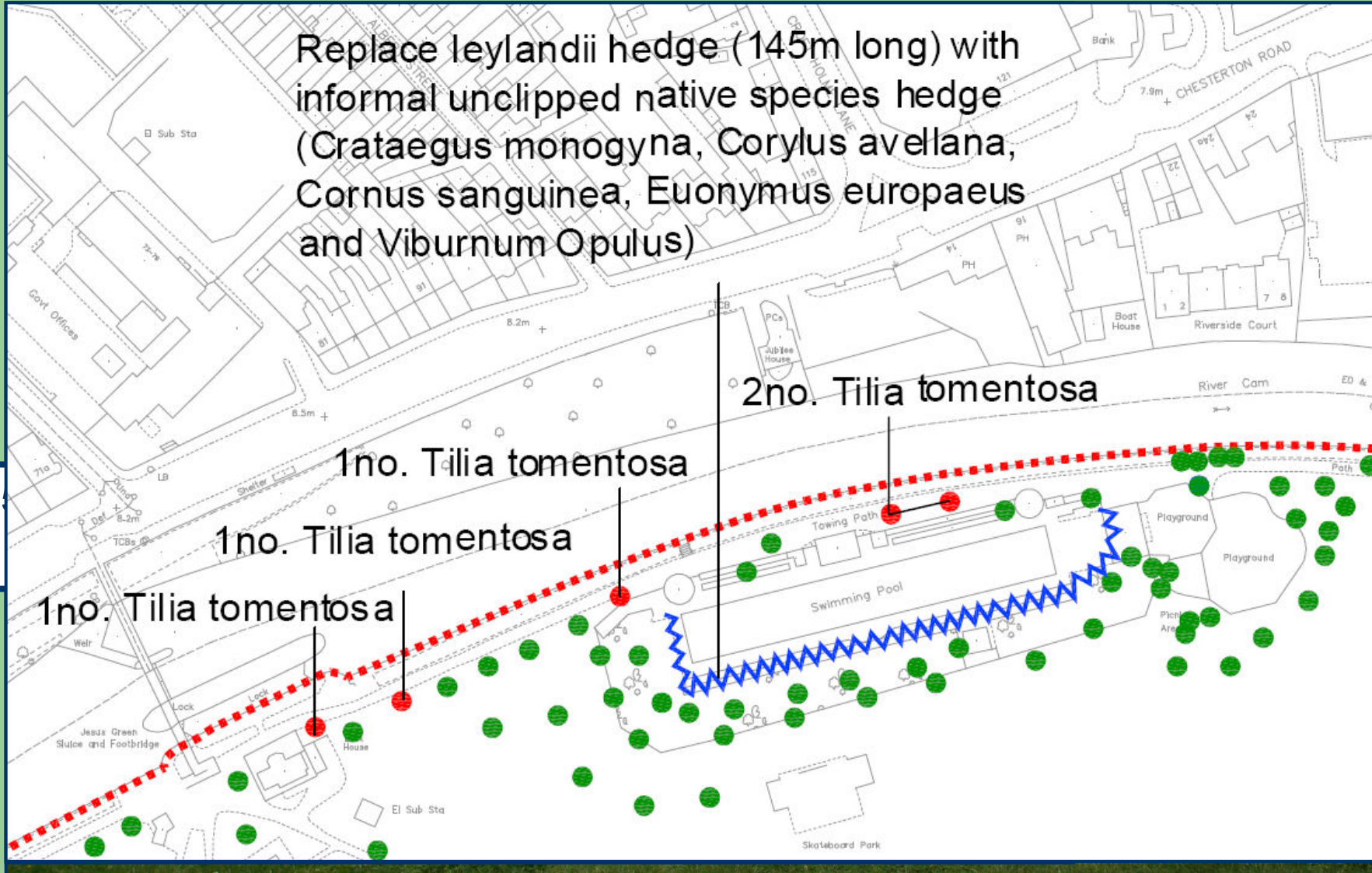







# Consultation & Resulting Proposals by Area

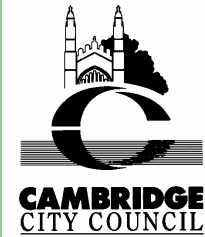

## AREA L - Towpath

Page 38

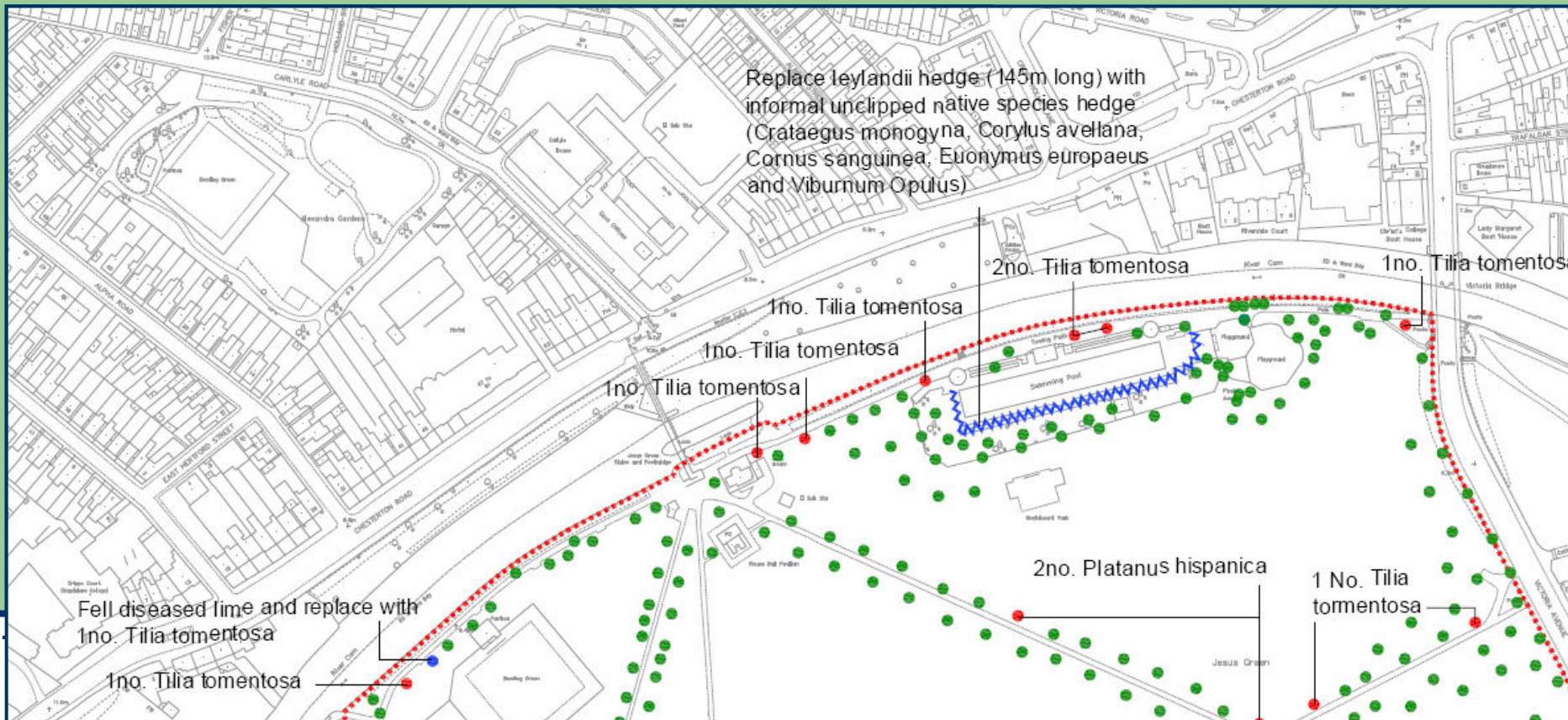

79.1% agreed with the suggestion to plant Lime to the south of the towpath.

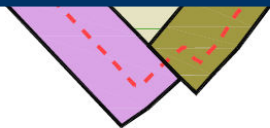



# MIDSUMMER COMMON

## Summary of Proposals

- Existing tree stock 108.
- Proposed to increase to 158.
- 50 new trees and 10 replacements.
- All new trees will include the necessary cattle guards.

# JESUS GREEN

## Summary of Proposals

- Existing tree stock 222.
- Proposed to increase to 242.
- 20 new trees and 4 replacements.
- Staged replacement of the Leylandii Hedge.

# Summary of Tree Species Proposed

## Silver Weeping Lime



TILIA TOMENTOSA 'PETIOLARIS' (Silver Weeping Lime)

# Small Leaved Lime



Black Poplar



# White Willow



# Pollarded Willow



# London Plane





# TREE PROTOCOL PROCEDURE

- Applies to all Trees owned by the City Council that are proposed to be replaced or removed.
- 2 week consultation with notices on affected trees.
- Objections presented to Planning Committee [17<sup>th</sup> November 2010] which will make a recommendation to the Executive Councillor for Arts & Recreation.
- Decision made by Executive Councillor in conjunction with the Director for Environment.

## ESTIMATED SCHEME COSTS

Replacement Works	-	£5000
Supply of new trees	-	£12,000
Planting & Watering	-	£13,000
Cattle Protection	-	£20,000

TOTAL ESTIMATED COST - £50,000

# DELIVERY PROGRAMME

Decision by West/Central Area Committee	23 <sup>rd</sup> September 2010
Brunswick Terrace/North Terrace Consultation	27 <sup>th</sup> September 2010 to 25 <sup>th</sup> October 2010
Tree Protocol Procedure for replacement trees	October to November 2010
Planting of trees not linked to Tree Protocol	October to December 2010
Planting of replacement trees subject to result of Tree Protocol Process	December 2010

# QUESTIONS